

# LAND-MARK SURVEYING

Mark L. Miritz

Wisconsin Registered Land Surveyor S-2582

N9330 Knuteson Drive  
Whitewater, WI 53190  
Phone: (262) 495-3284  
FAX : (262) 495-8421  
LAND-MARKSURVEYING.COM

## CEDAR POINT DRIVE

50' WIDE

N 88°54'18" E 84.93'

66.12'

65.94'

shed  
0.2'  
ROOF OF SHED  
ENCROACHES  
0.2'

power pole

## PLAT OF SURVEY

**LOT 1 OF CEDAR POINT SUBDIVISION  
LOCATED IN SECTION 28, TOWN 2 NORTH,  
RANGE 16 EAST, WALWORTH COUNTY,  
WISCONSIN.**

ORDERED BY: TOM McQUINN  
322 KENOSHA  
WALWORTH, WI. 53184

OWNER: ERNA DEJORIS  
1585 STEEPLECHASE CT.  
GREEN OAKS, IL. 60048

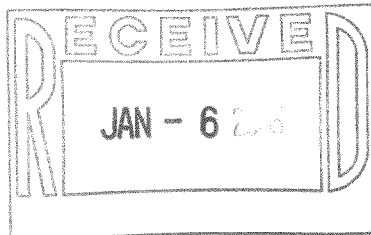

WEST LINE OF LOT 1 WAS ASSUMED TO BEAR  
NORTH TO MATCH PREVIOUS SURVEYS OF RECORD

161.40'

NORTH 363.05' +/-

**LOT 1**  
30,754 s.f.  
0.71 ac.

LOT 2

BLACKTOP DRIVEWAY

SHED

overhead util.

0.3' W. OF LINE

N 00°00'48" W 356.90'

126.10'

POWER POLE

1' wide concrete  
channel for drainage

0.5' W. OF LINE

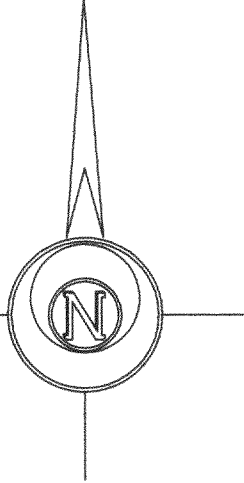
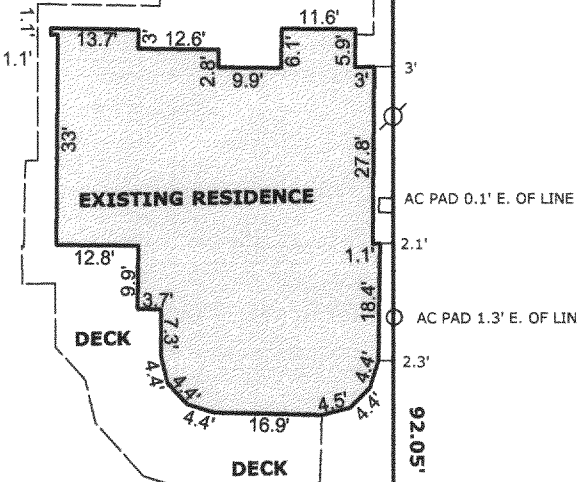

## LEGEND

- FOUND IRON PIPE
- FOUND IRON ROD
- FOUND COUNTY MONUMENT
- FOUND CONCRETE MONUMENT
- CHISEL CUT IN CONCRETE
- SET IRON ROD, 24" LONG, WEIGHING 1.5 LBS./LINEAL FT., 3/4" DIA.
- ( x x ) RECORDED AS DIMENSION
- x - x - EXISTING FENCE

SCALE: 1" = 30 FEET

"I hereby certify that the above described property has been surveyed by me or under my direction and that the above map is a true representation thereof and shows the size and location of the property, its exterior boundaries, the location of all visible structures and dimensions of all principal buildings thereon, boundary fences, apparent easements, roadways and visible encroachments, if any."  
"This survey is made for the use of the present owners of the property, and also those who purchase, mortgage, or guarantee the title thereto within one year from date hereof."

*Mark L. Miritz*  
MARK L. MIRITZ  
WISCONSIN REGISTERED  
LAND SURVEYOR S-2582  
DATE: SEPT. 17, 2004 JOB NO. 04.907

**DELAVAN LAKE**  
100 YEAR FLOOD ELEVATION = 929.0'  
AND FALLS ON LAKESIDE OF RIP RAP

REVISED NOV. 6, 2004 TO  
SHOW GARAGE FOUNDATION AS BUILT  
REVISED JAN. 4, 2005 TO  
SHOW OLD GARAGE REMOVED